



Technical Rider

Physical Address

195 West Washington St.
Athens, GA 30601

Phone Numbers

Administration: 706.613.3770
Box Office: 706.613.3771
Office Fax: 706.613.3773
Technical Director: 706.296.7503

Lynn Green
Managing Director

Stephen Verner
Technical Director

Zaria Gholston
Rental Coordinator/Box Office Manager

Asher Hill
Assistant Technical Director

CONTENTS

SEATING CAPACITY	3
STAGE SPECIFICATIONS	3
LOAD IN AND FACILITIES	3
DRESSING ROOMS	4
SOFT GOODS	4
FLY SYSTEM/RIGGING	4
RIGGING SCHEDULE	5
SUPPORT EQUIPMENT	5
LIGHTING SYSTEM AND EQUIPMENT	6
HOUSE LIGHTING CONTROL	6
DIMMERS AND PATCH	7
STAGE LIGHTING INSTRUMENTATION	8
AUDIO REINFORCEMENT SYSTEM	9
CONSOLE	9
SPEAKERS	9
PROCESSORS/AMPLIFIERS	9
AUDIO INVENTORY	10
VIDEO SYSTEM	10
STAGE DIAGRAM	11

MORTON THEATRE

Seating Capacity: **480**

- 434 Fixed Seats with an additional 46 Bleacher Seats
- 6 Wheel chair Spaces
- Raked House

- The Morton Theatre is **NOT** a Union House.
- The Morton Theatre is a **SMOKE-FREE** Facility.
- **No** Foods or Beverages are allowed in the auditorium or on stage.

STAGE SPECIFICATIONS:

Stage	Dimensions
Depth of Stage @ Centerline - Proscenium to Last Batten	22 ft. 2 in.
Proscenium Opening - Height	18 ft. 6.5 in.
Proscenium Opening - Width	26 ft. 10 in.
Full out trim of line set	38 ft. 10.5 in.

Stage Floor Construction:

Proscenium stage with concrete slab covered by a gymnasium-type hardwood floor.

Stage Crossover:

- There is a crossover located upstage behind the last line set.
- A hallway through the chorus level dressing room runs underneath the stage from Stage-Right to Stage-Left.

Backstage Entrances:

- Stage-Right: from the Chorus Level Star Level Dressing Rooms, House-Right, and Lobby
- Stage-Left: from the Chorus Level Dressing Room and House-Right

LOAD IN AND FACILITIES:

Loading Door: Width: 4' – 0" Height: 9'- 0" Height above ground: 17'- 0"

*Please Note: The Morton Theatre's loading door is located on the west side of the building, roughly **17' - 0" above the street level**. A forklift is available for loading in/out (see rate sheet). You must use the Morton Theatre's certified operator. The stage is also accessible from a stairwell on the west side of the building. All loading is performed from the west side of the building and there are no elevators for equipment. Temporary parking for load ins/outs can be found in the red zone on the corner of Hull St. and W. Washington St. and is first-come.*

DRESSING ROOMS (2 levels):

Star Level

- Located on the Ground floor, 2 stories below the stage
- Three (3) small dressing rooms to accommodate 4-5 persons each
- In each room: mirror, make-up lights, wardrobe hanging rack, sink and toilet.
- There is an audio feed to each room and the hallway to monitor show progress.

Chorus Level

- Located directly under the stage with the Orchestra Pit entrance in hallway
- Two (2) large dressing rooms to accommodate 12-15 persons each
- Each dressing room has a hanging rack, washbasins, toilets and showers.
- Each dressing room connects to the make-up corridor that has full-length counters, make-up mirrors, and lights.

SOFT GOODS:

- Two (2) Legs - 22' 0" high X 8' 0" wide
- Three (3) Borders - 8' 0" high X 32' 0" wide
- Main Curtain - 22' 0" high X 32' 0" wide: on traveler track: rigged for flying or drawing
- Main Teaser - 8' 0" high X 32' 0" wide
- Mid-Stage Traveler - 22' 0" high X 32' 0" wide: on traveler track: rigged for flying or drawing
- Back Blackout curtain - dead-hung: rigged for flying
- Bleached White Cyclorama*- 22' 0" high X 32' 0" wide: Rigid Pipe in Bottom: Rigged for flying (Additional Charge for Use)
*(Deposit may be required if used for high activity or high-risk show)

The Main Teaser and Main Curtain are blue velour. All other Draperies are black velour.

FLY SYSTEM/RIGGING:

- The rigging system is a single purchase, J-guide counterweight system with 24 line-sets operated from the stage floor with a loading gallery just below the gridiron.
- Fly Rail Location: Stage Right
- Working Height of Grid: ~ 42' - 0"
- 24 battens upstage of the Proscenium (32 ft. long. Please note that only 7 are free)
- Full out trim of a line set: 38 ft. 10.5 in.
- Working Load Capacity of each line set after balancing pipe weight: ~700 lbs
- All pipes are 1 ½" schd 40 with 8' arbors.

Please note: Electrics, cyc, travelers, main teaser, legs, borders, and the projection screen cannot be moved from their present locations.

RIGGING SCHEDULE:

Line #		Distance from Plaster Line
24.	Bleached White Cyc (Fixed)	21' - 11"
23.	Rear 2-part Black (Fixed)	21' - 2"
22.	Killed	20' - 5"
21.	3rd Electric (Fixed)	19' - 8"
20.	Open (Restricted)	18' - 2"
19.	Open	17' - 5"
18.	3rd Legs (Upstage) (Fixed)	16' - 8"
17.	3rd Border (Upstage) (Fixed)	15' - 1"
16.	Open	15' - 2"
15.	Open	14' - 5"
14.	Open	13' - 8"
13.	Mid-stage Black (Traveler/2nd Legs) (Fixed)	12' - 11"
12.	2nd Electric (Fixed)	12' - 2"
11.	Open (Restricted)	10' - 8"
	DH- Projection Screen (Fixed)	9' - 11"
10.	Open	9' - 2"
9.	1 st leg	8' - 5"
8.	Border w/ mics	7' - 8"
7.	Open	6' - 11"
6.	Open	6' - 2"
5.	Open (Restricted)	5' - 5"
4.	1 st Electric (Fixed)	4' - 8"
3.	Movie Screen (~26' W x 18' H) (Fixed)	3' - 2"
2.	Main Curtain (Fixed)	2' - 5"
1.	Main Teaser (Fixed)	1' - 8"
	FC Fire Curtain Mounted in Smoke Pocket	0' - 5"

SUPPORT EQUIPMENT (available at additional cost):

- Three (3) platforms 4' X 8' X 16"
- Mirror (Disco Ball)
- Bleached white drop (cyc)
- Sable Frame 2 Series by Elite Screens, 16:9 – 81" H x 144" W, Projection screen rigged for flying (*Free with rental of DLP projector*)
- Movie Screen (~ 18' H x 26') Rigged for flying
- One (1) Yamaha P-125 digital piano
- One (1) Young Chang concert baby grand piano (Stage use only with Morton management approval)

Please note: Electrics, sky cyc, travelers, main teaser, and the projection screen cannot be moved from their present locations.

LIGHTING SYSTEM AND EQUIPMENT:

THEATRICAL LIGHTS:

The Theatrical lighting console is an **ETC Ion Xe 2k with ETC EOS FW 20 fader wing**. The console is located in the control booth at the rear of the upper balcony. The control console runs off of two universes of 5-pin DMX and has the following system capacities:

- 2,048 or 12,288 Outputs
- 32,768 Control Channels (mapped to any number from 1 to 99,999)
- 100,000 Cues
- 999 Cue Lists
- 999 Submasters
- 100 Fader Pages
- 4 x 10,000 Palettes (Intensity, Focus, Color, Beam)
- 10,000 Presets (all palette)
- 10,000 Groups
- 10,000 Effects (relative, absolute or step)
- 99,999 Macros
- 10,000 Snapshots
- 10,000 Curves
- 10,000 Color Paths
- 99 discrete users
- Partitioned control
- Show import from Obsession, Express™, Expression®, Emphasis®, Congo®, Cobalt®, Grand MA 1, Grand MA 2, Safari and Strand 500/300 Series
- Augment3d 3D programming and visualization environment, with support for augmented reality features via connected phone or tablet app
- Magic Sheets suite for customized user programming and displays
- Virtual Media Server function for pixel-mapping effects, images, and animations
- Support for multiple languages, including English, German, Spanish, French, Italian, Japanese, Korean, Russian, and Chinese (Simplified and Traditional)
- USB ports to use with flash drives for show storage, keyboard, and mouse

HOUSE LIGHTS:

House lights are controllable through the lighting console or the independent architectural lighting system with:

- 4-button push station in the rear of house left of the orchestra (main) seating level.
- 4-button/3-zone fader station stage right (Stage Manager's post)
- 4-button/3-zone fader station in the lighting booth next to the light console

ELECTRICAL SERVICE:

There is one 100-amp/3-phase service located on Stage Left (*licensed electrician required for hook-up*).

LIGHTING POSITIONS:

- Three (3) hard-wired electrics on-stage on line sets 4, 12 and 21
- FOH 1 catwalk over house
- FOH 2 position over balcony
- Two (2) Torm positions, one each: House Left and House Right
- Two (2) Box Boom positions, one each: Balcony Left and Balcony Right
- One (1) Stage Right side light electric perpendicular to plaster line
- One (1) Stage Left side light electric perpendicular to plaster line

DIMMERS AND PATCH:

There are a total of 96 dimmers - ETC Express 2.4kw in dimmer-per-circuit configurations. All circuits are 3-pin slip stage plugs.

Outlets are located as follows:

- 4 Circuits each @ House-Left Box Boom (#21-24) and House-Right Box Boom (#25-28)
- 2 Circuits each @ House-Left Box Torm (#29-30) and House-Right Box Torm (#31-32)
- 20 Circuits in the FOH 1 lighting catwalk Slot (#1-20)
- 20 Circuits on the 1st Electric Batten (#33-52)
- 12 Circuits on the 2nd Electric batten (#53-64)
- 12 Circuits on the 3rd Electric batten (#65-76)
- 4 Circuits each @ Upstage-Right Box (#87-90) and Upstage-Left Box (#91-94)
- 1 Circuit in Center Orchestra Pit (#96)
- 5 Circuits each @ Stage Right plaster line Torm (#77-81) and Stage-Left plaster line Torm Box (#82-86) ****2-Fer'ed with the FOH2 position****

INSTRUMENTATION:

Instrument Type	Wattage	Quantity
Source 4 JR 36	575	15
Source 4 36	575	9
Source 4 26	575	16
Source 4 19	575	15
Altman Spectra Star PAR 100W (LED)	100	27
Altman PHX 250W Profile Leko (LED)	250	12
Source 4 LED Lustr+ w/ Cyc Light Lens	135	6
Lycian Superarc 400	400	3
Chauvet DJ Abyss 2 Water Effect LED	60	1
Chauvet DJ Intimidator Spot 110 LED Moving-head Spot	10	4

AUDIO REINFORCEMENT SYSTEM:

The house console is a Behringer X32-TP; 32 channel digital mixing console. The FOH mixing location is in the rear house right corner of the main seating area. This is a fixed position and will not be moved for any production. Patching to the stage is to stage left with S32 digital input snake head connected via shielded Cat 5 digital snake cable to the FOH console. All 32 inputs and 16 outputs are accessible on stage.

SPEAKERS:

- Mains- Two (2) JBL 215-6 (Bi-amped) and Two (2) JBL 215-9 (Bi-amped)
- Balcony Fill- Two (2) JBL JRX125
- Bass enclosures- Two (2) EV TL15-2 (each box contains two 15" Subwoofers)
- Monitors (All Passive) Four (4) JBL VRX915M 15 inch, 2-way

AMPLIFIERS:

- Two (2) Crown Audio XLS 1502 (bi-amped L/R Mains)
- One (1) Peavey CS3000 (Subs)
- One (1) Peavey CS3000 (Balcony Fill)
- Two (2) Peavey PV 900 (for 4 Monitor Mixes)

PROCESSORS:

- All signal processing is done internally through the Behringer X32 digital console

AUXILIARY INPUTS:

- One (1) Tascam CD-RW 750
- One (1) Tascam CD-200 CD player
- One (1) Stanton C402 CD player

AUDIO EQUIPMENT INVENTORY:

WIRED MICROPHONES

- Seven (7) Shure SM57 – wired instrument mic
- Seven (7) Shure SM 58 handheld wired vocal mic
- One Sennheiser 602ii kick drum mic
- One Sennheiser 901 boundary plate condenser microphone. Half-cardioid pattern.
- One (1) Shure PG52 kick drum mic
- Two (2) Shure SM81- small-diaphragm cardioid condenser mics
- Four (4) Shure SM 94 - small-diaphragm cardioid condenser mics
- Four (4) Crown PCC 160 surface-mounted supercardioid condenser boundary floor mics
- Four (4) Shure Centraverve overhead cardioid condenser suspended choir mics
- Two (2) sE Electronics sE4400a Large-diaphragm Condenser Microphone

WIRELESS MICROPHONES

- Four (4) 3000 Series Audio-Technica Wireless Mic Kits – 2 can be used as handhelds or lavs/bodypacks
- Five (5) Shure SLX Wireless Mic kits – can be used as handhelds or lavs/bodypacks

Mic and music stands, DI boxes, additional analog patch snakes, and various audio cables (XLR, ¼", etc.) are provided as needed according to the quantity of each we have on hand in our inventory.

VIDEO SYSTEM

- Christie Digital LWU720i-D 3 LCD Projector (8100 Lumens), with a native resolution of WUXAG (1920 x 1200)
- Roland V1HD 4 input scaler/switcher with in-booth preview video monitor and HDMI output to projector.
- Your HDMI-capable input device can be located on stage, at the FOH sound booth, or in the projection booth. Signal is sent from FOH or stage uncompressed at 1080p resolution and up to 60fps via 3G-SDI cable to our projector.
- 3 Screen choices:
 - Large format movie screen of 18' x 26' at the front of stage proscenium (covers entire stage opening).
 - Sable Frame 2 Series by Elite Screens, 16:9 – 81" (6.75') H x 144" (12') W projection screen flown at mid-stage (bottom of screen is at 7' above stage)
 - Bleached White cyc rigged permanently at 21' 11" upstage of the proscenium

STAGE DIAGRAM:

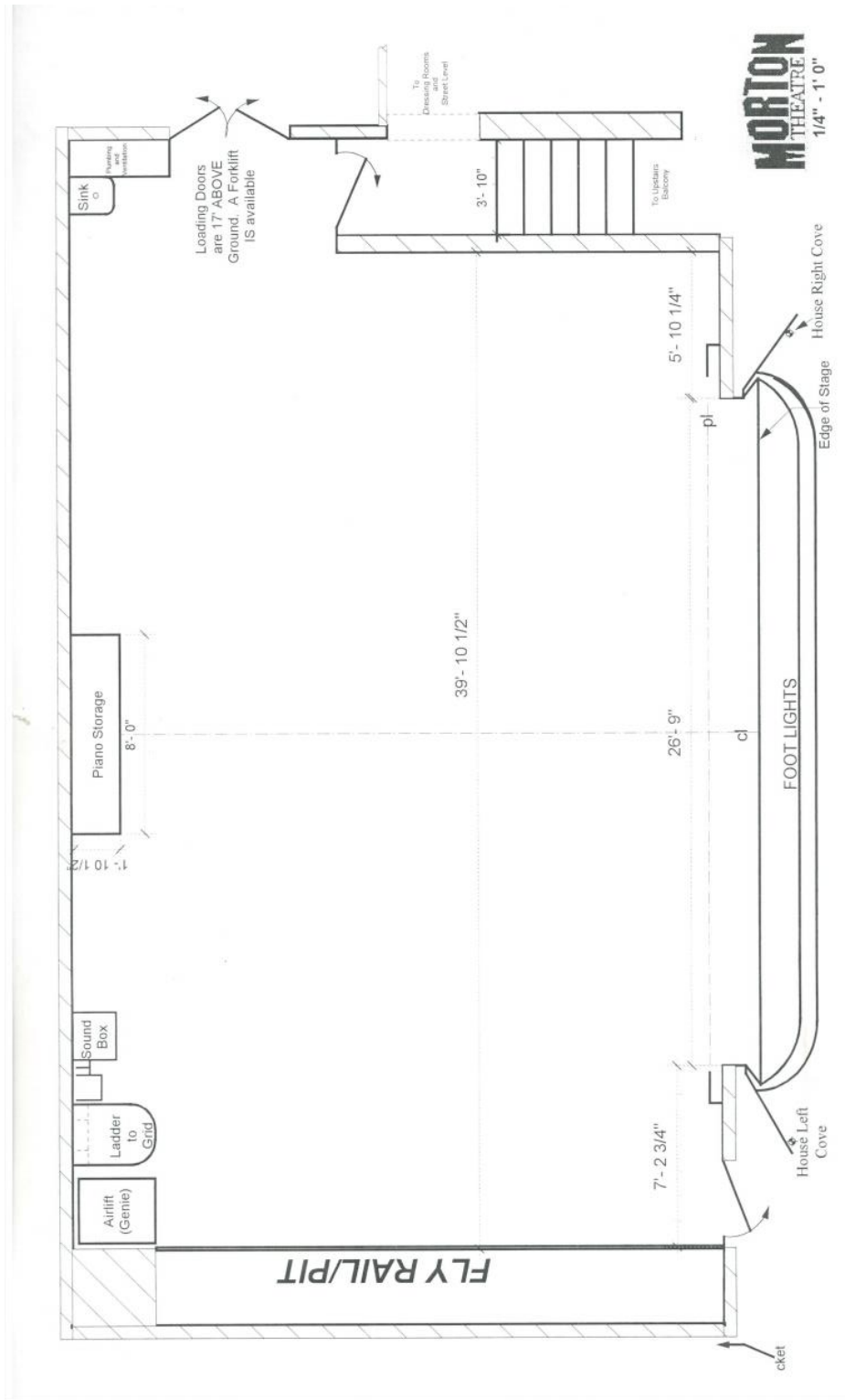

UPDATED – 7/17/23 - MORTON THEATRE TECHNICAL SPECIFICATIONS